

AEOLUS

Professional Vet Equipments Supplier



AEOLUS

Stainless Steel Electric Bathing Tub

BTS-231E

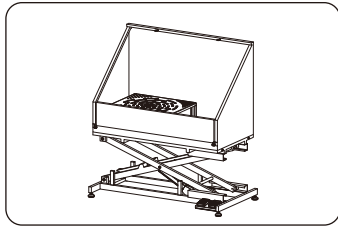

BTS-132TE

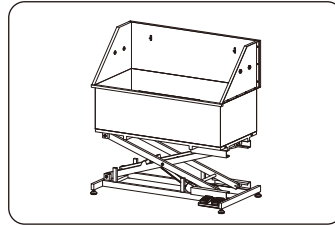

BTS-136E

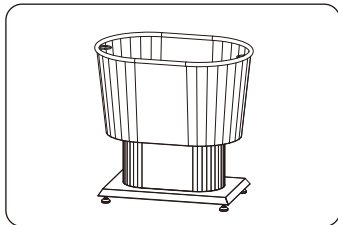

BTS-161

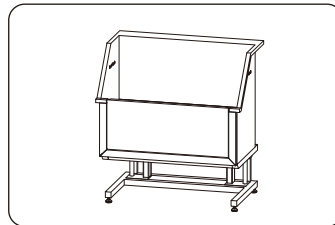

BTS-139E

Distributor Contacts



AEOLUS

Producer: Shanghai TOEX International Trading Co., Ltd.
Address: Floor 5, Building 6, No.675 Zhujin Road,
Songjiang District, Shanghai, 201615, China

Manufacturer: Shanghai Xunyuan Industrial Co., Ltd.
Address: Lane 29, No.1509 East Qianming Road,
Fengjing Town, Jinshan District, Shanghai.

New
Generation



User Manual

www.AEOLUSpet.com

AEOLUS BTS-231E Stainless Steel Electric Bathing Tub is designed for animal bathing. It features a smooth lifting electric base, splash guards, deluxe SUS304 stainless steel panels, an easy-to-use sliding door, elevated overhead grooming arm, a water sprayer holder, restraint loops, storage basket, alloy sprayer, anti-slippery bottom mat, puppy booster, water resistant foot pedal controls, stainless steel hair strainer, two tub floor panels, waste pipe. (Powered by Denmark Linak Actuator & Transformer & Foot Pedal)

Package Inspection

The manufacturer is not liable for any damage caused by a third party "Transport or Delivery Company".

The day the unit is delivered, an inspection of the outer packing should be made for any damage to the packing box.

Then the unit should be unpacked carefully; all components, accessories and the table itself should be inspected for any damage or loss of components.

If any damage is evident, the carrier or dealer should be notified immediately.

Parameters

Net weight:	97.3kg
Gross weight:	123.7kg
Dimension:	51×27×43-69"inch 130×69×109.5-175.5cm
Package:	134×74×81cmH
Volume:	0.8cbm

Safety Warning

1. Use only as described in this manual. Use only manufacturer's recommended attachments.
2. To reduce the risk of fire, or electric shock – DO NOT use outdoors or on wet surfaces. DO NOT place the product on an uneven or soft ground.
3. This product is not intended for use by persons (including children) with reduced physical, sensory or mental capabilities, or lack of experience and knowledge, unless they have been given supervision or instruction concerning use of the product by a person responsible for their safety. Children should be supervised to ensure that they do not play with the product.
4. DO NOT use with damaged cord or plug.
5. DO NOT cut, damage, or modify the cord. DO NOT pull or carry by cord, use cord as a handle, close door on cord, or pull cord around sharp edges or corners. DO NOT pull, twist, or bend the cord with unnecessary force. DO NOT run the product over cord. Keep cord

away from heated surfaces. DO NOT place heavy objects on the cord or allow the cord to get pinched in between objects. DO NOT wind the cord around the product.

6. DO NOT unplug by pulling on cord. To unplug, grasp the plug, not the cord.
7. DO NOT handle plug or the product with wet hands.
8. Turn off all controls before unplugging.
9. DO NOT use the product near flammable or combustible liquids such as gasoline or use in areas where they may be present. The fumes from these substances can create a fire hazard or explosion.
10. DO NOT modify, disassemble or repair.
11. Make sure the local voltage and frequency of the power meet the requirements on the label of the product.
12. Avoid using the product in dusty, vibrating and wet environment and in chemical storage place.
13. Neither people nor animals are allowed to be under the tub especially when it is power-on.
14. Gently control the tub to rise or lower slowly and safely.

Parts List (the number in the [] indicates the quantity of the parts)



BTS-231E

- ① Tub Basin [1]
- ② Electric Base [1]
- ③ Tub Splash [3]
- ④ Overhead Grooming Arm [1]
- ⑤ Fixture Ring [1]
- ⑥ Storage Basket [1]
- ⑦ Alloy Sprayer [1]
- ⑧ Sprayer Holder [1]
- ⑨ Faucet [1]
- ⑩ Sliding Door [1]
- ⑪ Restraint Loops [2]
- ⑫ Hair Catching Drainage [1]
- ⑬ Anti-slippery Bottom Mat [1]
- ⑭ Puppy Booster [1]
- ⑮ Waste Pipe [1]

Assembly Instructions

1. Unpack and Place the Tub Basin (1) onto the Electric Base (2). Connect them tightly with screws.
2. Assemble the Tub Splash (3), the largest plate is on the back, and two smaller ones on both sides.
3. Place the Tub Splash (3) onto the Tub Basin (1), and connect them with screws.
4. Pull the Overhead Grooming Arm (4) to a proper length, and fasten it with screws. Connect it with the side splash plates with screw. Connect the Restraint Loops (11) with the Overhead Grooming Arm (4).
5. Put the Hair Catching Drainage (12) in the drain hole of the Tub Basin (1) and securely bolt it to the Waste Pipe (15).
6. Screw the Fixture Ring (5), Storage Basket (6), Sprayer Holder (8) onto the back plate.
7. Screw the Faucet (9) onto the side plate, and connect it with Alloy Sprayer (7) by hose.
8. Put The Anti-slippery Bottom Mat (13) and Puppy Booster (14) in the Tub Basin (1).

Operation Instructions

1. Plug in the tub.
2. To bathe large breeds or older dogs, step on the down pedal to lower the tub and open the sliding door to allow them to stroll in. To bathe small breeds, step on the up pedal to raise the tub to a suitable level for user's stature (and/or by adding a booster rack).
3. Start a shower.
4. After the shower, let the water out of the tub and take the animal out.
5. Unplug the tub and clean it with a cloth.

Parts Replacement

Electric motor replacement

1. Disconnect the powder cord from the wall socket. Remove the tabletop from the frame assembly, and set it aside. Remove the grooming arm.
2. Disconnect the electric motor cable from the motor control unit. Remove the snap rings and

- the retaining bolts that hold the electric motor to the frame assembly. (See Figure 1 and 2)
- Using help, lift the frame assembly up, and remove the entire motor assembly from the frame.
 - Install the new motor assembly in the reverse order. Re-connect the cable to the motor control unit.
 - Plug the power cord into a wall socket and test the table for proper operation.

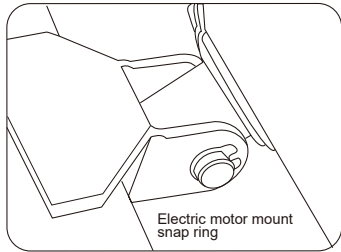

Figure 1

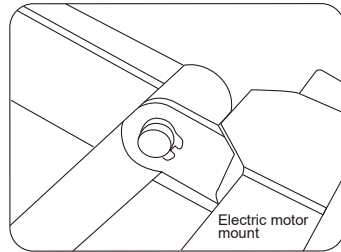

Figure 2

Control pedal replacement

- Disconnect the powder cord from the wall socket.
- Remove the three screws holding the control pedal to the frame assembly.
- Disconnect the control cable connector from the motor control unit. (See Figure 3)
- Install a new pedal in the reverse order, and re-connect the cable to the motor control unit.
- Plug the power cord into a wall socket and test the table for proper operation.

Transformer replacement

- Disconnect the powder cord from the wall socket.
- Disconnect the power cable connector from the control pedal. (See Figure 3)



Figure 3

- Disconnect the control cable connector from the electric motor unit. (See Figure 4)
- Take the transformer off the mounting rack.
- Install a new transformer in the reverse order. (See Figure 5)



Figure 4



Figure 5

Maintenance

In between usages, the tub should be cleaned with a soft cloth or sponge using a mild cleaning agent.

Service Support

Contact us if you cannot solve your problem with this manual.

Dallas
11307 Indian Trail, Dallas, Texas 75229, USA.
Tel: +1 469 930 6359
Web: www.aeoluspet.com

Shanghai
Floor 5, Building 6, No. 675, Zhujin Road, Songjiang District, Shanghai, China.
Tel: +86-21-67632060, 67632364